

# Installation Instructions

## Spine Mound

Part # LFoo3



**ID SCULPTURE**

PLAY. CLIMB. EXPLORE.

591 South Boulevard Street  
Gunnison, Colorado 81230  
info@idsculpture.com  
970-641-1747

### Specifications: Spine Mound Landform

- Material: Polyurea on Structural Foam
- Approximate Uninstalled Size: 11'-9" x 5'-2" x 2'-0"
- Approximate Weight: 100 Lbs
- Maximum Fall Height: 2'-0" (assumes 4" of protective surfacing)
- Age Group: 2-5 Years Old

### Required Parts (included):

- Spine Mound Landform Sculpture
- 1/2"-13 Threaded Rod (36" Length)
- Simpson Set XP Epoxy Tube and Tip
- Great Stuff Can Foam: 1ct
- 6"x6"x1/2" PL Steel Backing Plate: 1ct
- 1/2"-13 SS Nut: 1ct
- 1/2" SS Washer: 1ct
- "Spine Mound" Drawing Set

### Recommended Equipment (not included):

- 18" DIA auger (or Post Hole Digger)
- .2 CUYDS of Concrete (9 - 80lb Bags) for concrete pier
- Concrete Mixer
- Hammer Drill
- 5/8" x 10" Concrete Drill Bit
- Air Compressor with Blow Tube
- Hole Brush
- Caulk Gun
- Hack Saw or Angle Grinder with Cut-Off Wheel
- Hand Saw or Foam Saw
- 3/4" Wrench

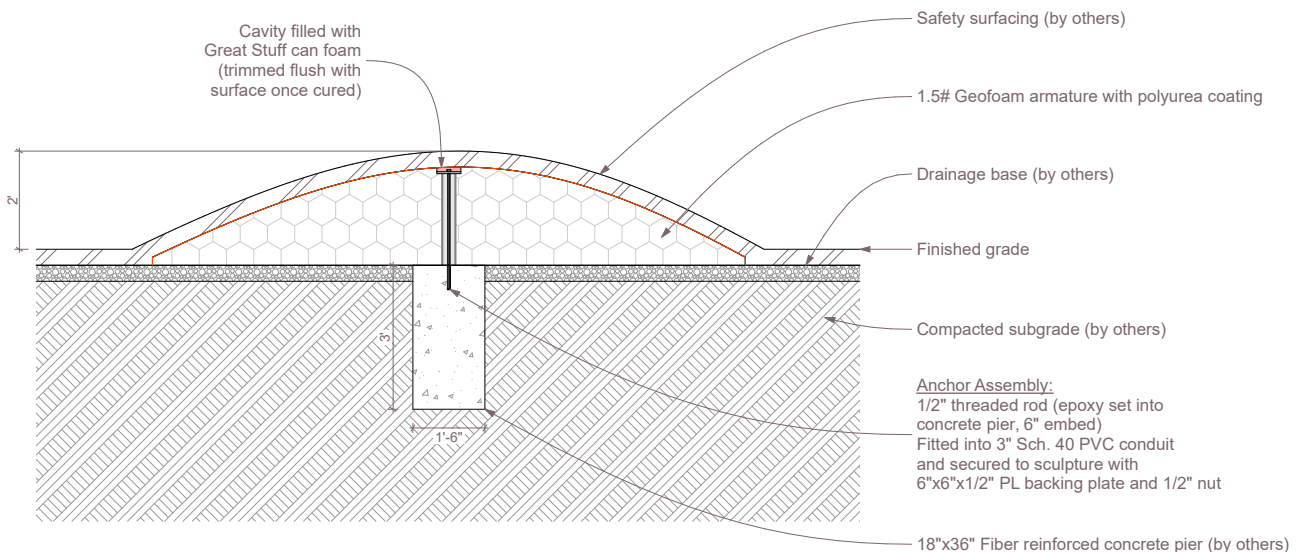

Section

# Installation Instructions

## Spine Mound

Part # LFoo3



591 South Boulevard Street  
Gunnison, Colorado 81230  
info@idsculpture.com  
970-641-1747

### PRE-INSTALL CHECKLIST

Please review prior to ordering and installing ID Sculpture products.

- ☐ 1. Verify that you have the recommended lifting equipment to unload and install your component, as specified by the installation instructions. Please check the installation instructions for the weight of each component and shipping dimensions.
- ☐ 2. Develop a proper plan to access the site and control access prior to opening.
- ☐ 3. Call your local utilities to locate any potential existing below grade equipment?
- ☐ 4. FOR ALL SCULPTURES: Verify you have accounted for adjustments to the footing depth based on your choice of safety surfacing material. Footing depth must be adjusted to compensate for the depth/thickness requirements of the selected safety surfacing (*see diagrams below*). Layout drawings show the uninstalled dimensions of the component. If you require a modification to a standard component, please notify ID Sculpture when placing your order. *Additional charges may apply.*
- ☐ 5. Verify that you have installed any required footings prior to the arrival of your sculptures. Please note, footings should be allowed to cure for a minimum of 7 days.

#### Important Safety Note:

Please install and maintain adequate protective surfacing under and around your equipment. Never let children play on the equipment before protective surfacing is installed. Please consult ASTM F1487 for more information.

# Installation Instructions

## Spine Mound

Part # LFoo3



591 South Boulevard Street  
Gunnison, Colorado 81230  
info@idsculpture.com  
970-641-1747

### Sculpture Installation:

1. Locate the concrete pier based on the provided layout drawing. Please refer to ASTM 1487 for layout guidelines.
2. Dig hole for the concrete pier into the compacted subgrade with an 18" diameter auger (or posthole digger) to a depth of 36".
3. Fill hole with concrete. Allow for concrete to cure for a minimum of 24 hours before installing landform.
4. Fill drainage base over compacted subgrade to be level to the top of the concrete pier as per the provided layout drawing. Level drainage base layer with rake and shovel.
5. The landform will get anchored to the concrete pier using epoxy set 1/2" threaded rod placed through a built-in anchor conduit, and secured using a backing plate and nut. The threaded rod anchor segment is cut slightly over length to ensure that the mounting hardware is properly installed.
6. Drill into the center of the concrete pier with a 5/8" x 10" hammer drill bit to a depth of 6" (do not exceed), clean hole with compressed air and brush.
7. Fill hole with the provided Simpson Set XP epoxy, and place the threaded rod segment into the epoxy filled hole. Allow a minimum of 24 hours of cure time before securing backing plate to threaded rod.
8. Once epoxy is cured, use at least 2 people to hand lift landform over threaded rod anchor and onto the concrete pier.
9. Place the provided 6"x6"x1/2" steel backing plate over the threaded rod anchor, then tighten and secure plate to threaded rod anchor using a provided 1/2" SS nut and washer.
10. Trim the threaded using a hack saw or angle grinder with cut-off wheel so that top of threaded rod sits flush or slightly below the opening of the anchor cavity.
11. Fill the anchor cavity above the backing plate with the provided Great Stuff can foam. Allow foam to cure and harden. Once the foam is set, use a foam saw or a hand saw to cut the foam flush with the surface of the landform module.
12. Install resilient surfacing material in accordance with layout guidelines, and ASTM standards.

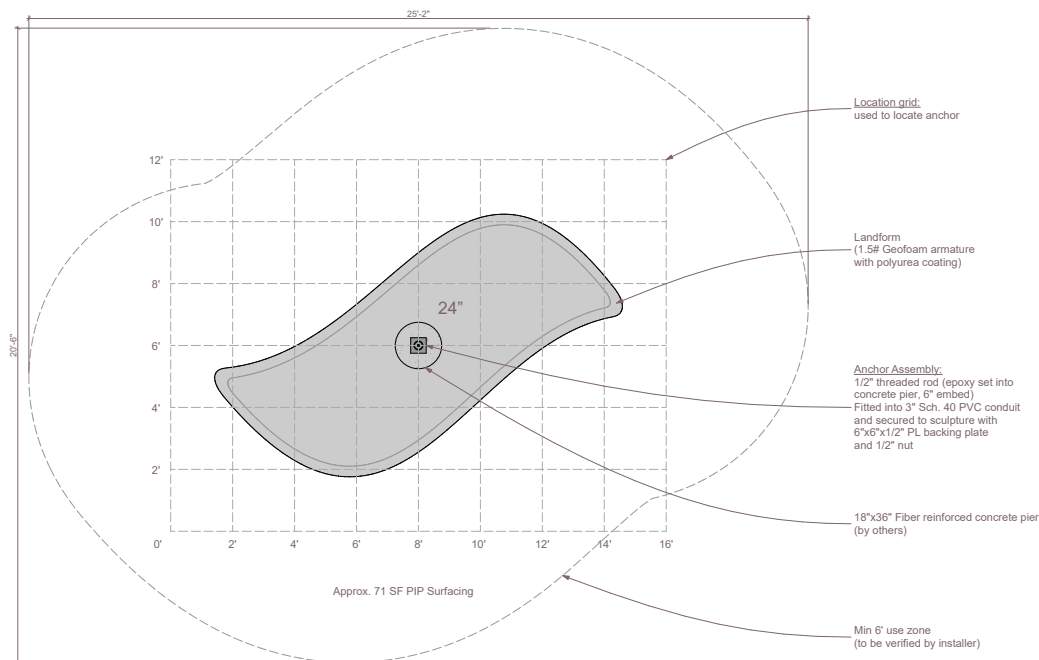

Plan